

LED	State	Description
Ports 1 and 2	Link (left) and Activity (right) Off	Not connected to the network.
	Link (left) Green	Connected to the network.
	Activity (right) Flashing Amber	Network data is being sent or received.
Ports 3 and 4 Left LED	Green	The correct cable is connected to the interface and the connected equipment has power.
	Flashing	Network activity at this interface.
Ports 3 and 4 Right LED	Green	The interface is connected at 1000 Mbps.
	Amber	The interface is connected at 100 Mbps.
	Off	The interface is connected at 10 Mbps.
LCD panel	Blue	Normal system operation. Flashes when the System ID button is pressed.
	Blue flashing	Both the systems management software and the identification buttons located on the front and back of the system can cause the LCD to flash blue to identify a particular system.
	Amber	System requires attention due to a problem with power supplies, fans, system temperature, or hard drives.
Power button	On	Indicates that power is supplied to the system and the system is operational.
	Off	Indicates that no power is supplied to the system.
Power supply status indicator	Green	Power supply is operational
Power supply fault	Amber	Problem with the power supply.
AC line status	Green	AC source is connected to power supply.
Hard drives	Green	Drive online.
	Slow green blinking	Drive rebuilding.
	Blinks amber 4 times per second	Drive failed.
	Blinks green, amber, and off	Rebuild aborted.
	Blinks green 2 times per second	Identify drive/preparing for removal.
	Off	Drive ready for insertion or removal.

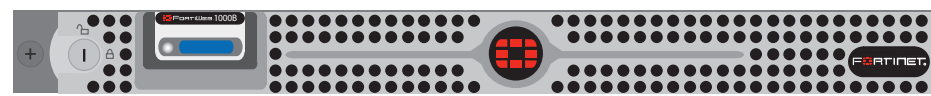

© Copyright 2008 Fortinet Incorporated. All rights reserved.
 Products mentioned in this document are trademarks or registered trademarks of their respective holders.
 Regulatory Compliance
 FCC Class A Part 15 CSA/CUS
 29 January 2010

16-30003-883377-20081022

Package Contents

Connector	Type	Speed	Protocol	Description
Ports 1 to 4	RJ-45	10/100/1000 Base-T	Ethernet	Copper gigabit connection to 10/100/1000 copper networks.
CONSOLE	DB9	9600 8/N/1	RS-232 serial	Optional connection to the management computer. Provides access to the command line interface (CLI).
USB	USB		USB	Four (2 front and 2 back) optional connections to a USB key for firmware installation.
Hard drives	1 TB			One 3.5" 1TB hard drive is provided. Can support up to two hard drives.
Serial				Connects a serial device to the system. Baud Rate 9600, Data bits 8, Parity None, Stop bits 1.
System ID button				The ID buttons on the front and back panels are used to locate a system in a rack. When one of these buttons is pushed, the LCD panel on the front and the System Status indicator on the back flash blue until one of the buttons is pushed again.
Video				Two (one front and one back) ports that connects to a monitor system.

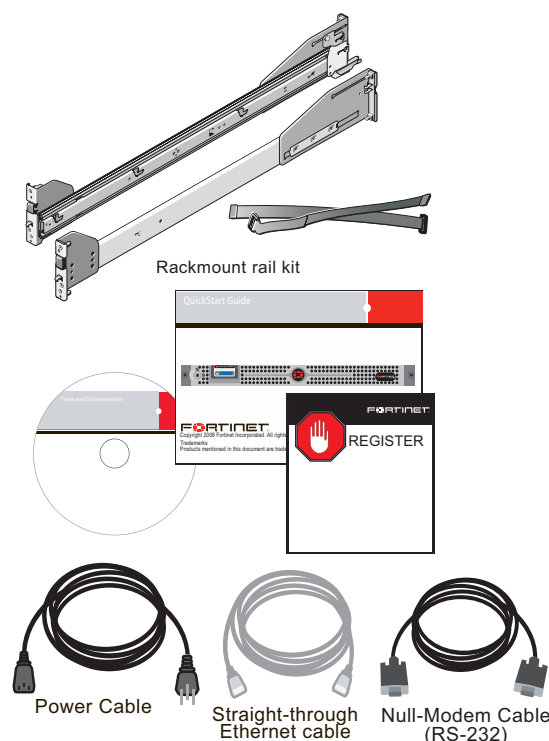
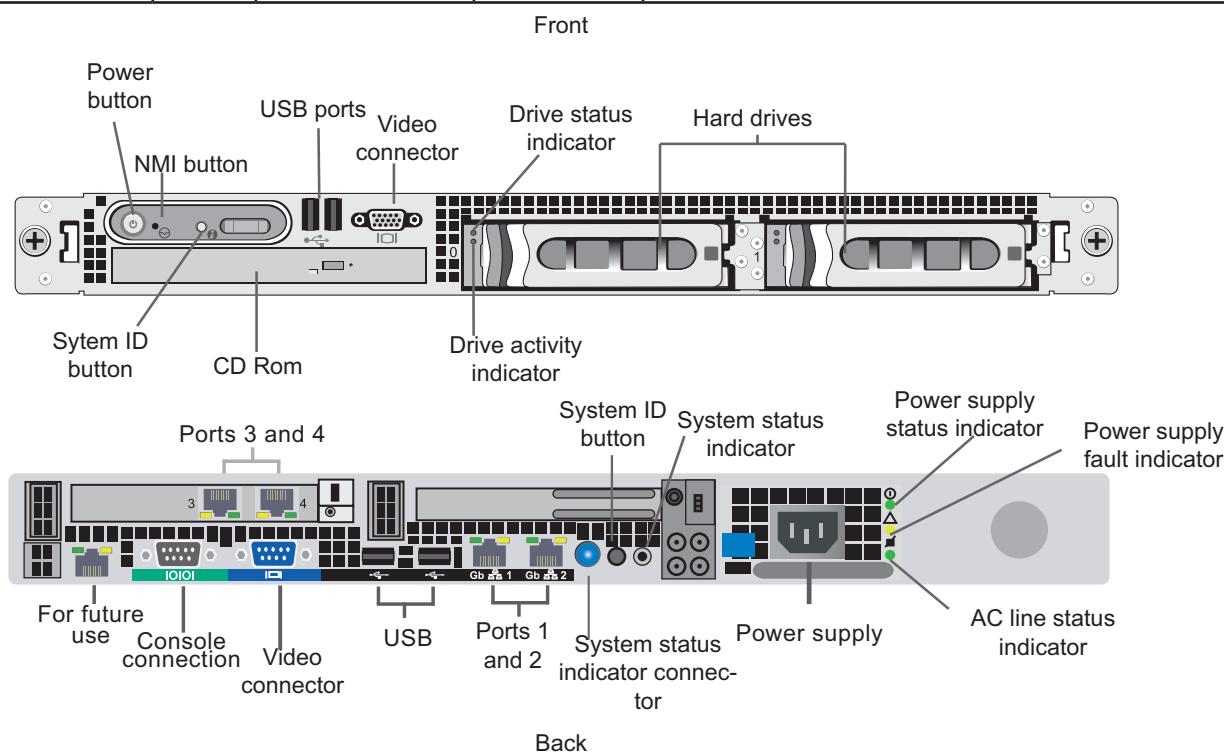

Connecting

Connect the following to the unit. Ensure the unit is placed on a stable surface or install in a standard 19 inch rack. See the *FortiWeb-1000B Rack Install Guide* for details.

- Assemble the rails and install the system in the rack following the safety instructions and the rack installation instructions provided with your system.
- Connect the system's power cable to the system.
- Bend the system power cable into a loop and secure the cable to the bracket using the provided tie wraps.
- Plug the other end of the power cable into a grounded electrical outlet or a separate power source such as an uninterruptible power supply (UPS) or a power distribution unit (PDU).
- Insert an Ethernet cable into the one of the 4 ports on the FortiWeb unit. Insert the other end to the router connected to the Internet, or to the modem.
- Press the power button on the system.

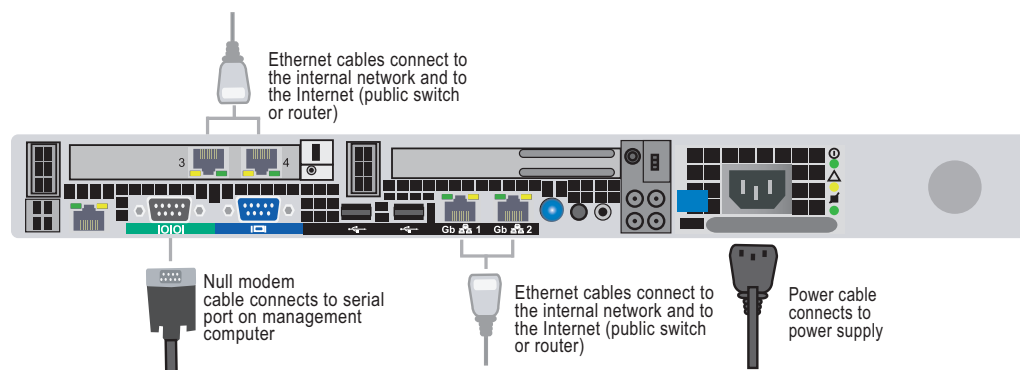

Configuration Tools

Web-based manager

The FortiWeb web-based manager is an easy to use management tool. Use it to configure the administrator password, the interface and default gateway addresses, add Fortinet devices and configure reports.

Requirements:

- An Ethernet connection between the FortiWeb unit and management computer.
- A web browser such as FireFox or Internet Explorer on the management computer.

Command Line Interface (CLI)

The CLI is a full-featured management tool. Use it to configure the administrator password, the interface addresses, the default gateway address, and the DNS server addresses. To configure advanced settings, see the Tools and Documentation CD included with the FortiWeb unit.

Requirements:

- The DB9 serial connection between the FortiWeb unit and management computer.
- A terminal emulation application (HyperTerminal for Windows) on the management computer.

Collecting Information

Port Information

Port 1	IP:	_____
	Netmask:	_____
Port 2	IP:	_____
	Netmask:	_____
Port 3	IP:	_____
	Netmask:	_____
Port 4	IP:	_____
	Netmask:	_____

The internal interface IP address and netmask must be valid for the internal network.

General settings

Administrator password:	_____	
Network Settings:	Default Gateway:	_____
	Primary DNS Server:	_____
	Secondary DNS Server:	_____

Factory default settings

Port 1 interface	192.168.1.99	Management IP	192.168.1.99:8443
Port 2 interface	192.168.2.99	Administrative account settings	
Port 3 interface	192.168.3.99	User name	admin
Port 4 interface	192.168.4.99	Password	(none)

To reset the FortiWeb unit to the factory defaults, in the CLI type the command
`execute factoryreset`

Configuring

Web-based Manager

Use the following procedure to connect to the web-based manager for the first time. Configuration changes made with the web-based manager are effective immediately without resetting the FortiWeb unit or interrupting service.

To connect to the web-based manager

1. Connect the Port 1 interface of the FortiWeb unit to Ethernet port of the management computer.
Use a cross-over Ethernet cable to connect the devices directly. Use straight-through Ethernet cables to connect the devices through a hub or switch.
2. Configure the management computer to be on the same subnet as the FortiWeb Port 1 interface.
To do this, change the IP address of the management computer to 192.168.1.2 and the netmask to 255.255.255.0.
3. To access the FortiWeb web-based manager, in your browser, go to `https://192.168.1.99:8443` (remember to include the "s" in `https://`).
4. Type `admin` in the Name field and select Login.

After connecting to the Web-based manager, you can configure the FortiWeb unit IP address, DNS server IP address, and default gateway to connect the FortiWeb unit to the network.

To configure interfaces

1. Go to **System > Network > Interface**.
2. Select the edit icon for each interface to configure.
3. Set the IP address and netmask for the interface.
4. Select OK.

To configure the Primary and Secondary DNS server IP addresses

1. Go to **System > Network > DNS**, enter the Primary and Secondary DNS IP addresses select Apply.

To configure a Default Gateway

1. Go to **Router > Static** and select Create New.
2. Set Gateway to the Default Gateway IP address and select OK.

Command Line Interface

The FortiWeb-1000B has serial port. Use the null modem cable to connect it to your management computer.

To connect to the FortiWeb unit

1. Use a null modem cable to connect the FortiWeb serial port to the management computer serial port.
2. Start a terminal emulation program (such as HyperTerminal) on the management computer. Use these settings: Baud Rate 9600, Data bits 8, Parity None, Stop bits 1, Flow Control None.
3. At the login: prompt, type `admin` and press Enter twice.
(The login prompt is preceded by the server default host name.)

After connecting to the CLI, you can configure the FortiWeb unit IP address, DNS server IP address, and default gateway to connect the FortiWeb unit to the network.

To configure the FortiWeb unit using the CLI

1. Set the IP address and netmask of the Port1 interface.

```
config system interface
  edit port1
    set ip <intf_ip>/<netmask_ip>
  end
```
3. Configure the primary and secondary DNS server IP addresses.

```
config system dns
  set primary <dns-server_ip>
  set secondary <dns-server_ip>
end
```
4. Configure the default gateway.

```
config router static
  edit 1
    set device <interface_str>
    set dst <destination_ip4>
    set gateway <gateway_ip4>
  end
```

Adding an administration password

By default, the admin user does not have a password. To restrict access to the FortiWeb unit management account, add password for the admin user account.

To add the admin user account password

1. Go to **System > Admin > Administrators**.
2. For the admin user, select the Change Password icon.
3. Enter a new password in the Password field.
4. Reenter the password to Confirm Password field.
5. Select OK.

Adding an administration password using the CLI

To add an administration password in the CLI enter the following commands:

```
config system admin
  edit admin
    set password <password>
end
```

Shutting down the FortiWeb unit

When powering off the FortiWeb unit, always shut down the unit using the following procedures before disconnecting the power supply. Not following this procedure can increase the risk of damaging the FortiWeb hard disk.

To shut down the FortiWeb unit using the CLI

- Enter the following command at the prompt:
`execute shutdown`

To shut down the FortiWeb unit using web config

1. Go to **System > Status** and click ShutDown in the System Information Dashboard.
2. Click OK.

Visit these links for more information and documentation for your Fortinet product.

Technical Documentation - <http://docs.fortinet.com>
Fortinet Technical Support - <http://support.fortinet.com>

Fortinet Knowledge Center - <http://kb.fortinet.com>
Training Services - <http://campus.training.fortinet.com>