

LED	State	Description
Ports 1 and 2 Left LED	Green	The correct cable is connected to the interface and the connected equipment has power.
	Flashing	Network activity at this interface.
Ports 1 and 2 Right LED	Green	The interface is connected at 1000 Mbps.
	Amber	The interface is connected at 100 Mbps.
	Off	The interface is connected at 10 Mbps.

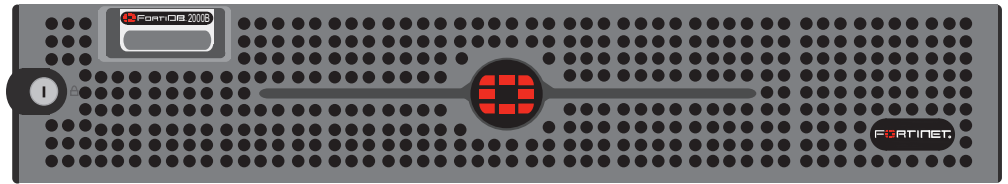

© Copyright 2009 Fortinet Incorporated. All rights reserved.
 Products mentioned in this document are trademarks or registered trademarks of their respective holders.
 Regulatory Compliance
 FCC Class A Part 15 CSA/CUS
 10 November 2009

15-40000-113537-20091110

Package Contents

Connector	Type	Speed	Protocol	Description
Ports 1 and 2	RJ-45	10/100/1000 Base-T	Ethernet	Copper gigabit connection to 10/100/1000 copper networks.
CONSOLE	DB9	9600 8/N/1	RS-232 serial	Optional connection to the management computer. Provides access to the command line interface (CLI).
USB	USB		USB	For diskless boot.

Front

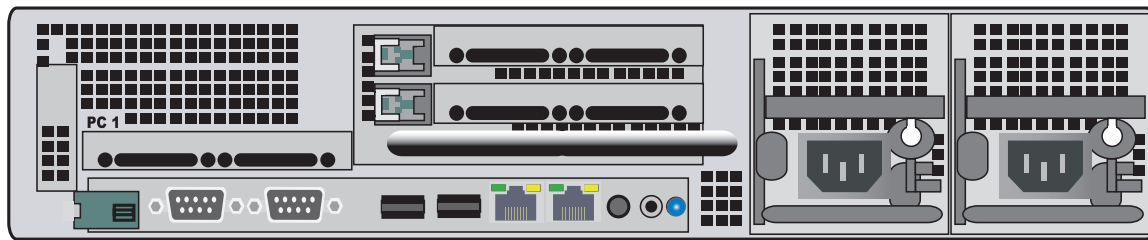
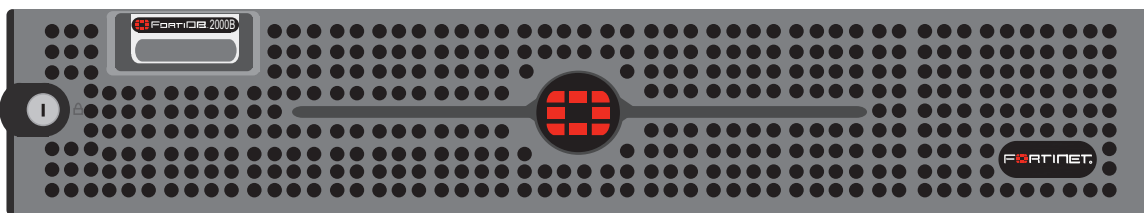

Console connection

USB Ethernet ports

Redundant power supply

Back

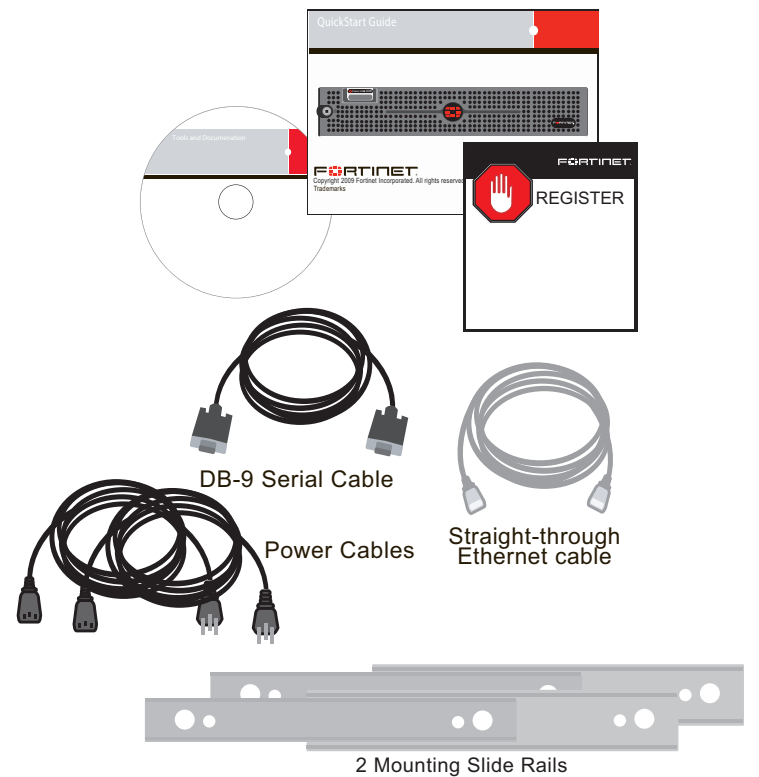

Connecting

Connect the following to the FortiDB unit. Ensure the FortiDB unit is placed on a stable surface or install in a standard 19 inch rack. See the *FortiDB-2000B Rack Install Guide* for details.

- Insert an Ethernet cable to port 1.
- Connect the other end of network cable to the network hub or switch.
- Connect the AC Power Cord to the Power Supply.
- Connect the Power Cord to a surge protected power bar or power supply.

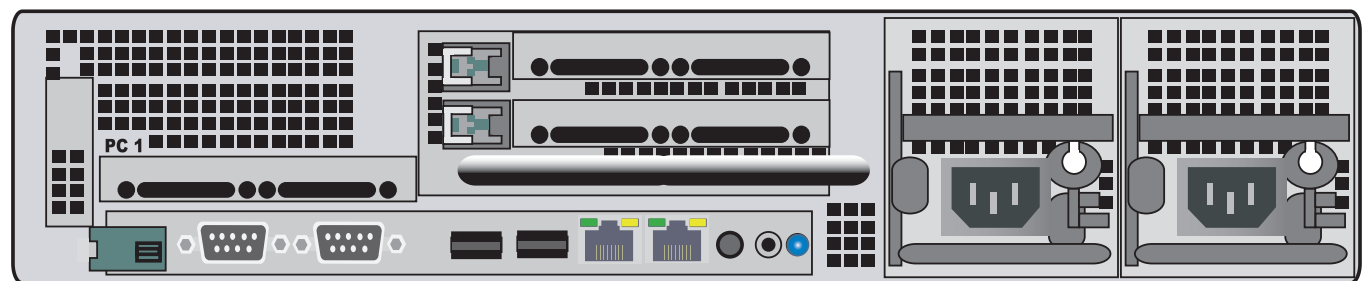

Console connection

USB Ethernet ports

Redundant power supply

Configuration Tools

Web-based manager

The FortiDB web-based manager is an easy-to-use management tool. Use it to configure the administrator password, the interface and default gateway addresses, add Fortinet devices and configure reports.

Requirements:

- An Ethernet connection between the FortiDB unit and management computer.
- A web browser such as FireFox or Internet Explorer on the management computer.

Command Line Interface (CLI)

The CLI is a full-featured management tool. Use it to configure the administrator password, the interface addresses, the default gateway address, and the DNS server addresses. To configure advanced settings, see the Tools and Documentation CD included with the FortiDB unit.

Requirements:

- The DB9 serial connection between the FortiDB unit and management computer.
- A terminal emulation application (HyperTerminal for Windows) on the management computer.

Port Information

Port 1	IP:	_____
	Netmask:	_____
Port 2	IP:	_____
	Netmask:	_____

The internal interface IP address and netmask must be valid for the internal network.

General settings

Administrative account settings	User name	admin
	Password	fortidb1!\$
Network Settings	Default Gateway:	_____
	Primary DNS Server:	_____
	Secondary DNS Server:	_____

A default gateway is required for the unit to route connections to the Internet.

Factory default settings

Port 1 interface	192.168.1.99
Port 2 interface	192.168.2.99
DHCP server on Internal interface	192.168.4.99

To reset the unit to the factory defaults, in the CLI type the command:
`execute factory reset`

Configuring

Web-based Manager

Use the following procedure to connect to the web-based manager for the first time. Configuration changes made with the Web Config are effective immediately without resetting the unit or interrupting service.

To connect to the web-based manager

1. Connect the Port 1 interface of the unit to Ethernet port of the management computer. Use a cross-over Ethernet cable to connect the devices directly. Use straight-through Ethernet cables to connect the devices through a hub or switch.
2. Configure the management computer to be on the same subnet as the Port 1 interface. To do this, change the IP address of the management computer to 192.168.1.2 and the netmask to 255.255.255.0.
3. To access the web-based manager, in your browser, go to `https://192.168.1.99` (remember to include the "s" in `https://`).
4. Type `admin` in the Name field, type `fortidb1!$` in the Password field, and click Login.

After connecting to the Web-based manager, you can configure the unit IP address, DNS server IP address, and default gateway to connect the unit to the network.

To configure interfaces

1. Go to **Appliance > Network > Interface**.
2. Click the edit icon to configure each interface.
3. Set the IP address and netmask for the interface.
4. Click OK.

To configure the Primary and Secondary DNS server IP addresses

1. Go to **Appliance > Network > DNS**, enter the Primary and Secondary DNS IP addresses click Apply.

To configure a Default Gateway

1. Go to **Appliance > Network > Static Routing** and select Create New.
2. Set Gateway to the Default Gateway IP address and click OK.

Command Line Interface

The unit has serial port. Use the null modem cable to connect it to your management computer.

To connect to the unit

1. Use a null modem cable to connect the serial port to the management computer serial port.
2. Start a terminal emulation program (such as HyperTerminal) on the management computer. Use these settings: Baud Rate 9600, Data bits 8, Parity None, Stop bits 1, Flow Control None.
3. At the login prompt, type `admin` for the user name and `fortidb1!$` for the password and press Enter.

After connecting to the CLI, you can configure the unit IP address, DNS server IP address, and default gateway to connect the unit to the network.

To configure the unit using the CLI

1. Set the IP address and netmask of the Port1 interface.

```
config fmsystem interface
  edit port1
    set ip <intf_ip>/<netmask_ip>
  end
```
3. Configure the primary and secondary DNS server IP addresses.

```
config fmsystem dns
  set primary <dns-server_ip>
  set secondary <dns-server_ip>
end
```
4. Configure the default gateway.

```
config fmsystem route
  edit 1
    set device <interface>
    set dst <destination_ip>
    set gateway <gateway_ip>
  end
```

Shutting down the unit using the CLI

Enter the following command at the prompt:

```
execute shutdown
```

Visit these links for more information and documentation for your Fortinet product.

Technical Documentation - <http://docs.forticare.com>
 Fortinet Knowledge Center - <http://kb.fortinet.com>
 Fortinet Technical Support - <http://support.fortinet.com>
 Training Services - <http://campus.training.fortinet.com>